



# Newbridge Appointed Taxi Byelaws 2015

As Adopted 20th January 2016

Kildare County Council

Roads Design Section,  
Áras Chill Dara, Devoy Park, Naas, Co. Kildare

Tel: +353-45-980424, Fax: +353-45-980420,  
E-mail: [roads@kildarecoco.ie](mailto:roads@kildarecoco.ie)

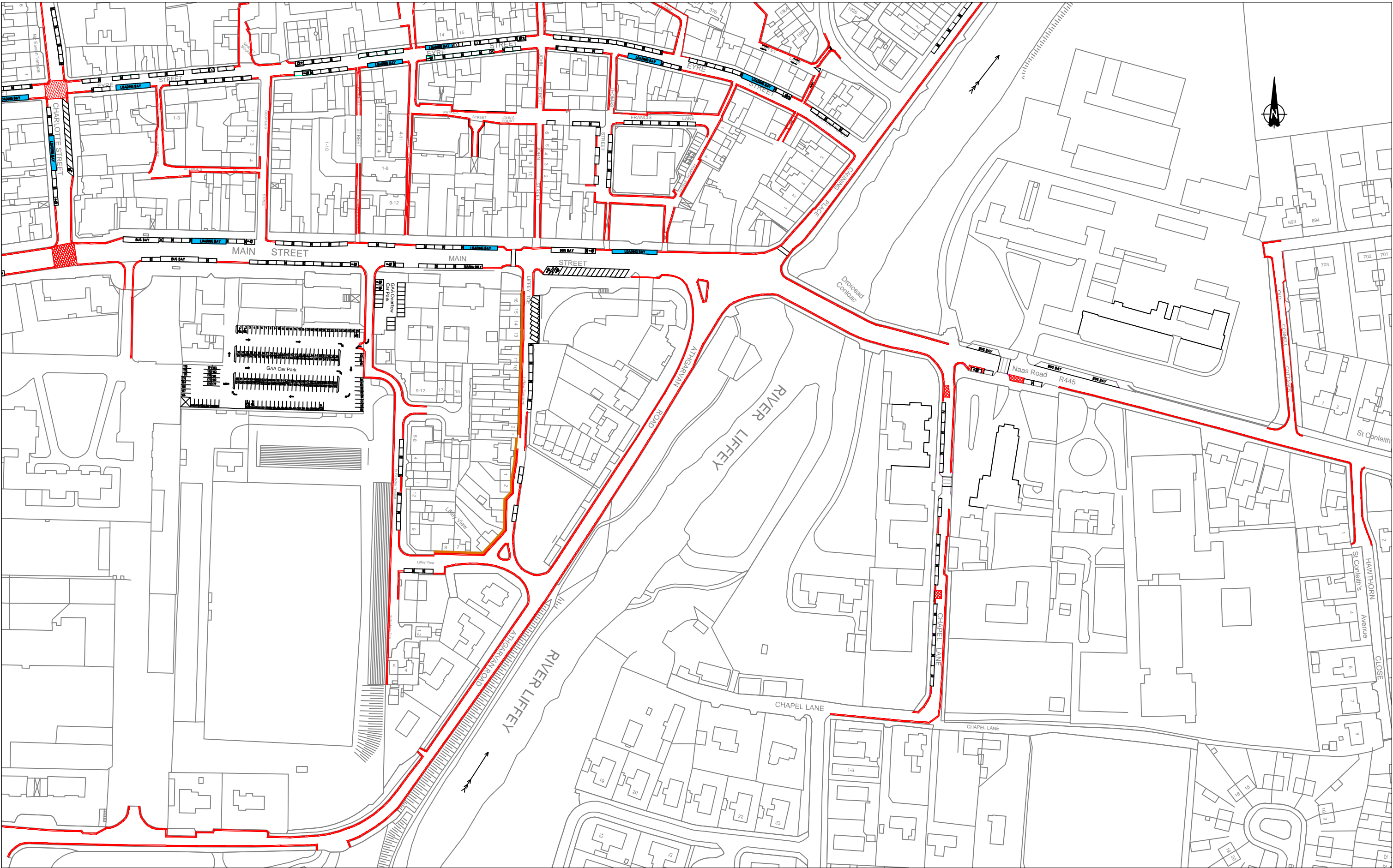

NOTES:

 SCHEDULE D (Loading/Parking/Taxi)	 SCHEDULE F (Appointed Taxi Stand)
---	--



**Kildare County Council**  
Roads Design Department

Roads Design Section, Aras Chill Dara, Devoy Park, Naas, Co. Kildare, Ireland  
Tel: +353-45-980424, Fax: +353-45-980420, e-mail: roads@kildarecoco.ie

MR. JOHN COPPINGER, BE, MIEI  
SENIOR ENGINEER  
Roads, Transportation

MR. NIALl MORISSEY  
DIRECTOR of SERVICE  
Roads, Transportation & Public Safety

Project: Newbridge Appointed Taxi Byelaws 2015 -  
As Adopted 20th January 2016

Drawing: Location Map

Date: Jan 2016

Scale 1 :2000

Drawn By: M.D.

E/3526/1A

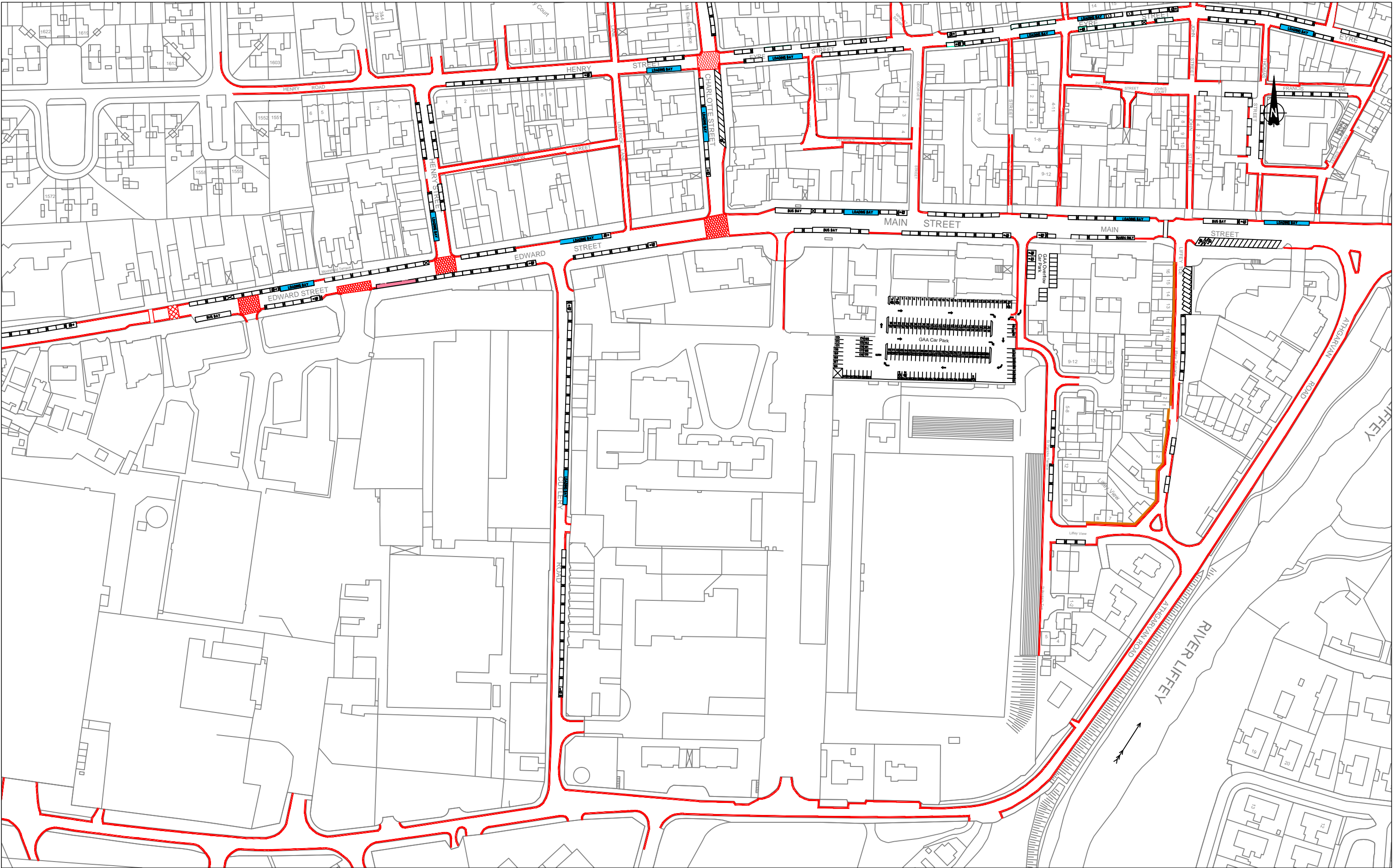

NOTES:

 SCHEDULE D  
(Loading/Parking/Taxi)

 SCHEDULE F  
(Appointed Taxi Stand)



MR. JOHN COPPINGER, BE, MIEI  
SENIOR ENGINEER  
Roads, Transportation

**Kildare County Council**  
Roads Design Department

Roads Design Section, Aras Chill Dara, Devoy Park, Naas, Co. Kildare, Ireland  
Tel: +353-45-980424, Fax: +353-45-980420, e-mail: roads@kildarecoco.ie

MR. NIAL MORISSEY  
DIRECTOR OF SERVICE  
Roads, Transportation & Public Safety

Project: Newbridge Appointed Taxi Byelaws 2015 -  
As Adopted 20th January 2016

Drawing: Location Map

Date: Jan 2016

Scale 1 :2000

Drawn By: M.D.

E/3526/1B



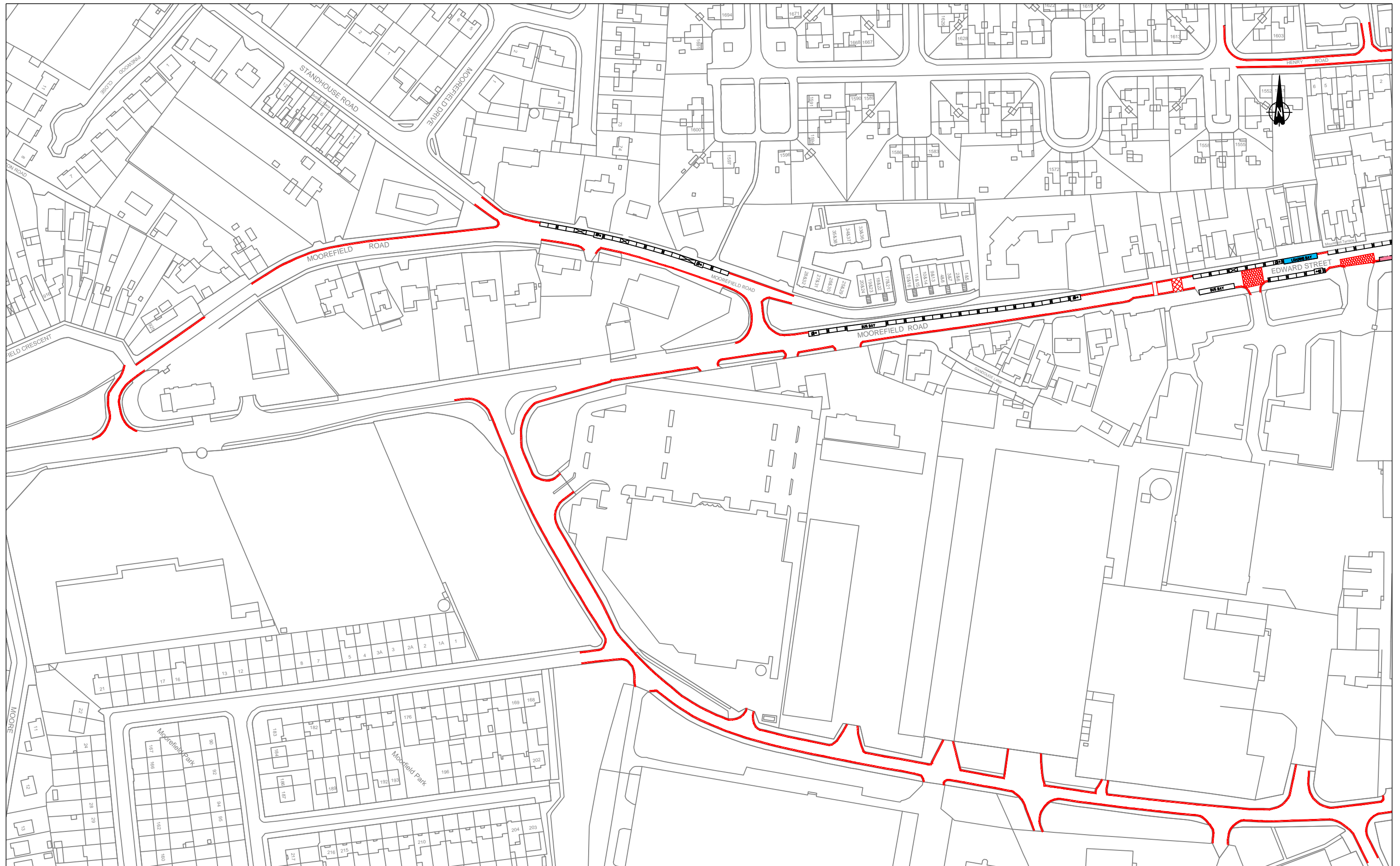

NOTES:

**SCHEDULE D**

 SCHEDULE F  
(Appointed Taxi Stand)



# Kildare County Council

Roads Design Department

Roads Design Section, Aras Chill Dara, Devoy Park, Naas, Co. Kildare, Ireland  
Tel: +353-45-980424, Fax: +353-45-980420, e-mail: roads@kildarecoco.ie

MR. JOHN COPPINGER, BE, MIEI  
SENIOR ENGINEER  
Roads, Transportation

MR. NIALL MORISSEY  
DIRECTOR of SERVICE  
Roads, Transportation & Public Safety

Project: Newbridge Appointed Taxi Byelaws 2015 -  
As Adopted 20th January 2016

Drawing: Location Map

Date: Jan 2016

Scale 1 :2000

Drawn By: M.D.

E/3526/1C

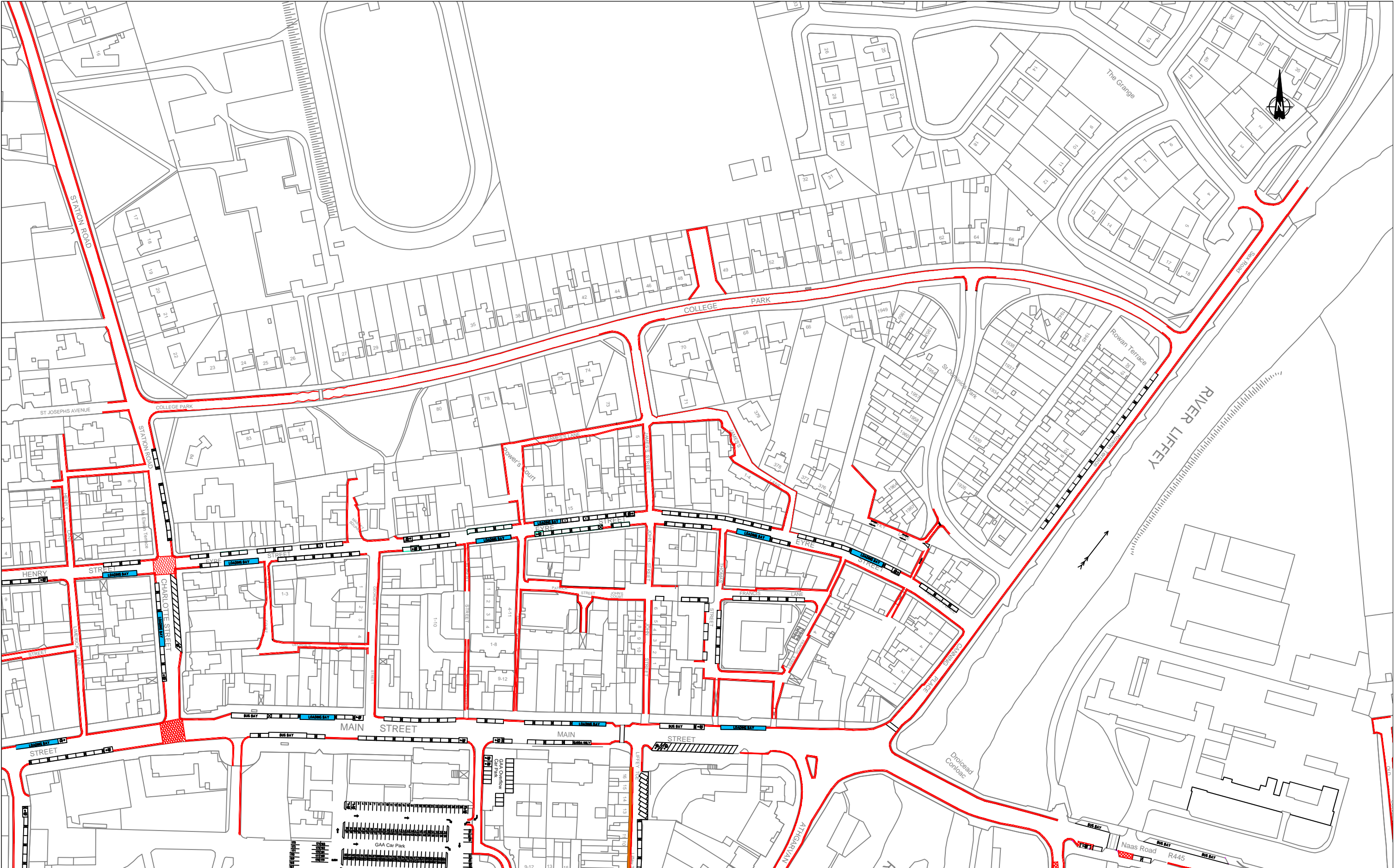

NOTES:

 SCHEDULE D (Loading/Parking/Taxi)	 SCHEDULE F (Appointed Taxi Stand)
---	--



**Kildare County Council**  
Roads Design Department

Roads Design Section, Aras Chill Dara, Devoy Park, Naas, Co. Kildare, Ireland  
Tel: +353-45-980424, Fax: +353-45-980420, e-mail: roads@kildarecoco.ie

MR. JOHN COPPINGER, BE, MIEI  
SENIOR ENGINEER  
Roads, Transportation

MR. NIALL MORISSEY  
DIRECTOR OF SERVICE  
Roads, Transportation & Public Safety

Project: Newbridge Appointed Taxi Byelaws 2015 -  
As Adopted 20th January 2016

Drawing: **Location Map**

Date: Jan 2016      Scale 1 :2000      Drawn By: M.D.

E/3526/1D